

# EZSET<sup>®</sup> RESIDENTIAL

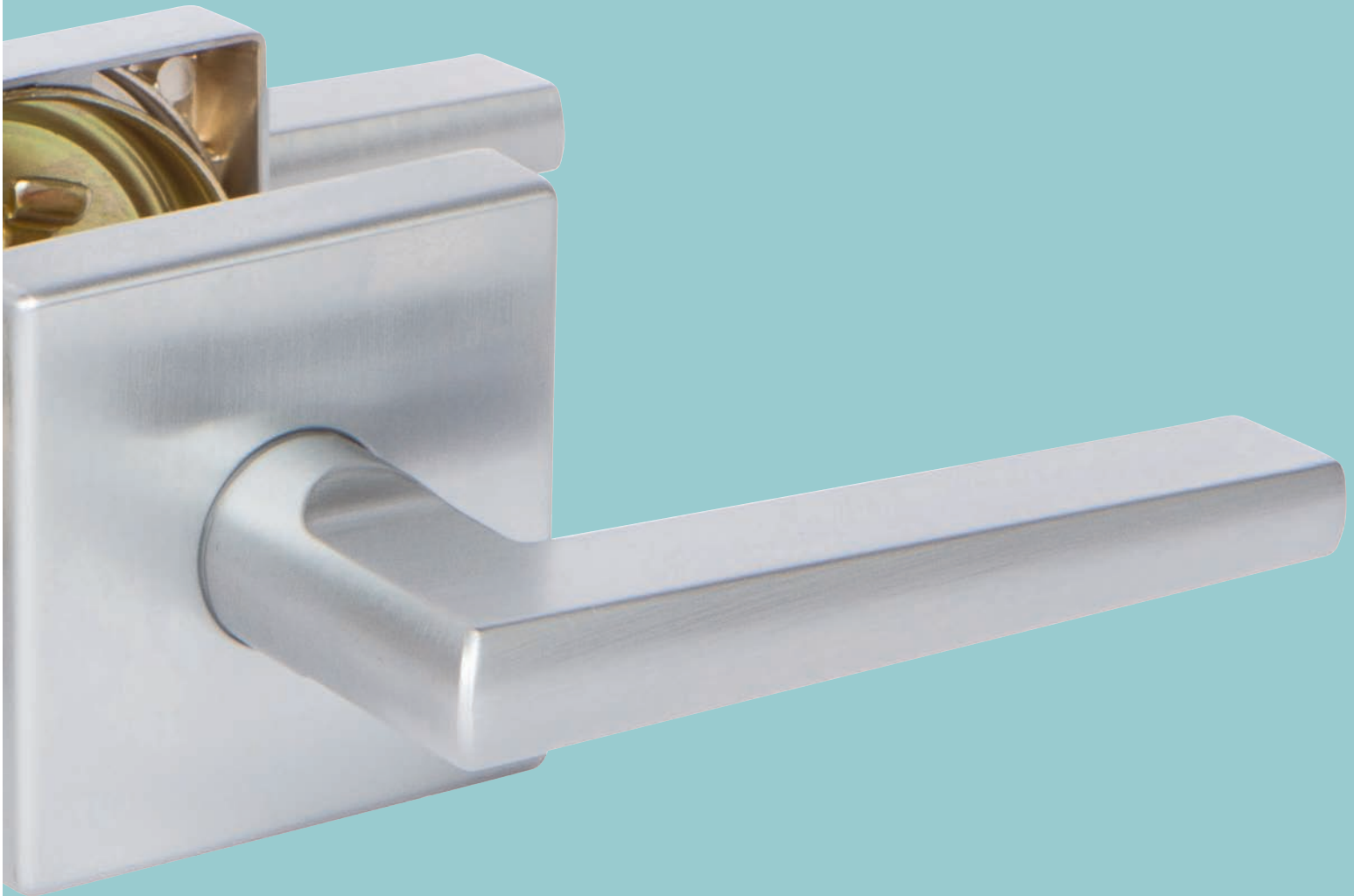

Always Striving.  
[philhardware.com](http://philhardware.com)

# Security Features

## 200B Series ANSI Grade 3 Certified Deadbolt

(ANSI/BHMA A156.36-2010) for Auxiliary Locks

Product meets and exceeds ANSI Grade 3 requirements for auxiliary locks

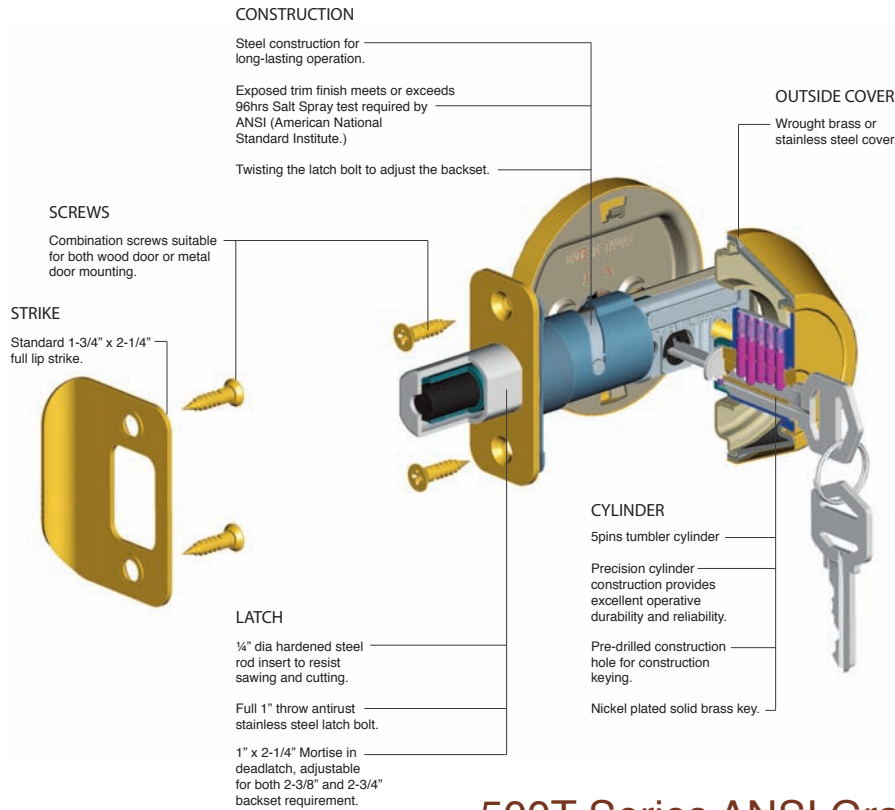

## 500T Series ANSI Grade 3 Certified Leverset

(ANSI/BHMA A156.2-2011) for bored & preassembled locks & latches

Product meets and exceeds ANSI Grade 3 requirements for single-point locks and latches

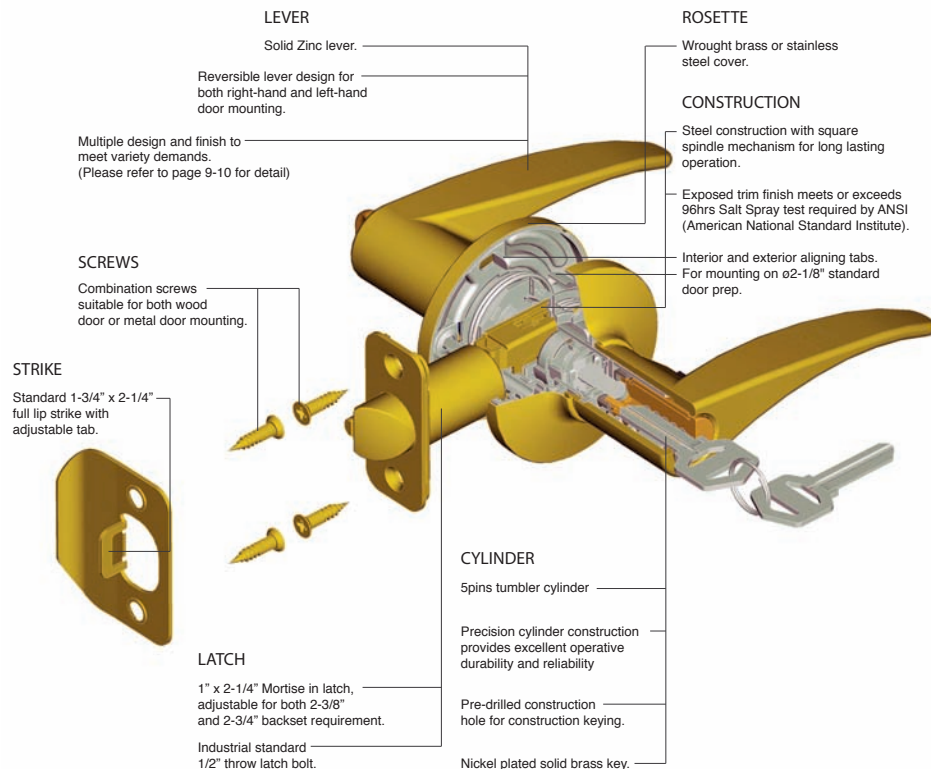

# Functions

## 400 Series Handleset – ANSI A156.2, Series 4000, Grade 3

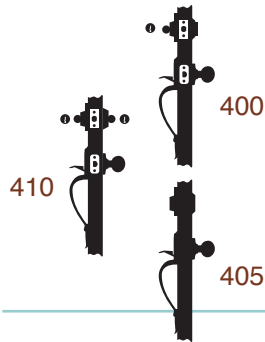

### 400 Single Cylinder Handleset

Deadbolt thrown or retracted by key from outside or by inside turnpiece. Latch retracted by thumbpiece from outside or by inside knob/lever.

### 400 Single Cylinder Interconnected Handleset (ANSI F102)

Deadbolt thrown or retracted by key from outside or by inside turnpiece. Latch retracted by thumbpiece from outside or by inside knob/lever. Both deadbolt and latch bolt are retracted to unlocked position by operating inside lever.

### 410 Double Cylinder Handleset

Deadbolt thrown or retracted by key from either side. Latch retracted by thumbpiece from outside or by inside knob/lever.

### 405 Dummy Handleset

For use as door pull or as dummy trim on inactive leaf of double door. Fixed thumbpiece and inside knob/lever. Dummy cylinder with inside plate.

## 500T Series Lever Lock – ANSI A156.2, Series 4000, Grade 3

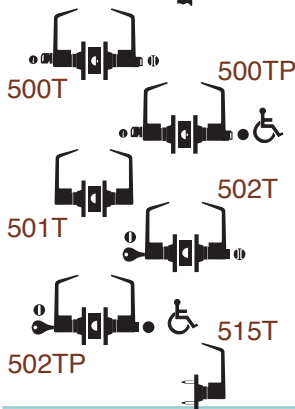

### 500T Entrance

Turn button lock/unlock outside lever. Key lock/unlock from outside.

### 500TP Entrance (Push Button)

Push inside button locks outside lever. Key lock/unlock from outside. Unlock by push down inside lever.

### 501T Passage

Both levers always unlocked.

### 502T Privacy

Turn inside button locks outside lever. Can be opened from outside using outside turn mechanism.

### 502TP Privacy (Push Button)

Turn inside button locks outside lever. Can be opened from outside using outside turn mechanism. Unlock by push down inside lever.

### 515T Dummy

Dummy trim for one side on door. Used for door pull or matching inactive trim.

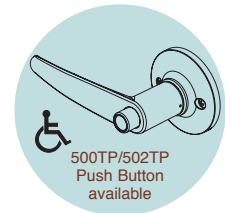

500TP/502TP  
Push Button  
available

## 100T Series Knob Lock – ANSI A156.2, Series 4000, Grade 3

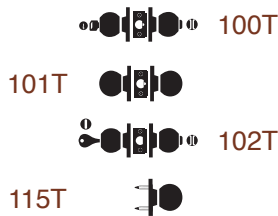

### 100T Entrance

Turn button lock/unlock outside knob. Key lock/unlock from outside.

### 101T Passage

Both knobs always unlocked.

### 102T Privacy

Turn inside button locks outside knob. Can be opened from outside using outside turn mechanism.

### 115T Dummy

Dummy trim for one side on door. Used for door pull or matching inactive trim.

## 200 Series Deadbolt Lock – ANSI A156.36, Grade 3

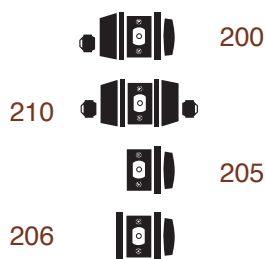

### 200 Single Cylinder

Deadbolt thrown or retracted by key from outside or by inside turnpiece.

### 210 Double Cylinder

Deadbolt thrown or retracted by key from either side.

### 205 One-sided Half-Bore

Deadbolt thrown or retracted by thumbpiece from inside.

### 206 One-sided Full-Bore

Deadbolt thrown or retracted by thumbpiece from inside. Cover plate outside.

## 300 Series Interconnected Locks – ANSI A156.12, Grade 3

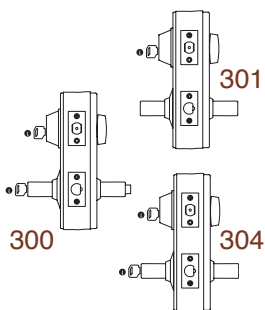

### 301 Entrance Single Locking, ANSI F95

Latch bolt operated by lever from either side. Deadbolt operated by turn from inside or key from outside. Operating inside lever retracted both deadbolt and latch bolt.

### 300 Entrance Double Locking, ANSI F97

Deadbolt operated by key from outside or by turnpiece inside. Deadlatch is locked by key from outside or by push button from inside. Turn inside lever to release deadbolt and latchbolt simultaneously for immediate exit. Latch deadlocks when door is closed.

### 304 Storeroom Double Locking, ANSI F98

Deadbolt operated by key from outside or by turnpiece inside. Outside lever is fixed, entrance by key only. Turn inside lever to release deadbolt and latchbolt simultaneously for immediate exit. Latch deadlocks when door is closed.

# Contemporary Design

## DEXTON HANDLESET



DEXTON (DT)  
US26

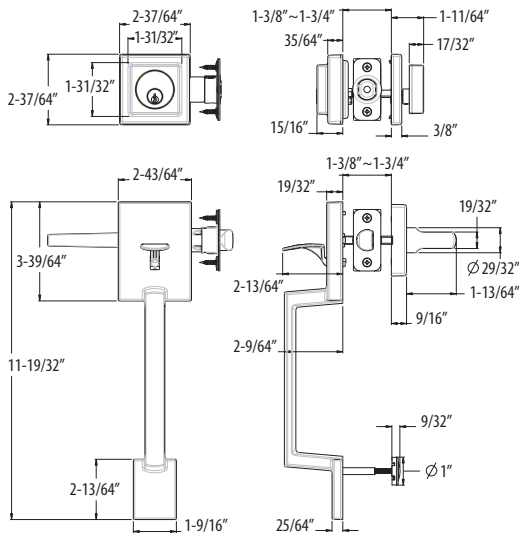

## AM SERIES LEVER



HOLLYWOOD (HW)  
US15

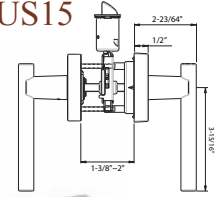

SOHO RC (SH) US26  
Round Rosette

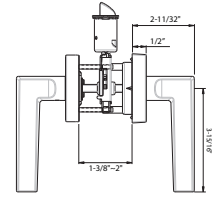

SOHO SQ (SH) US15  
Square Rosette

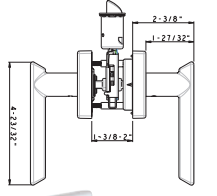

AUSTIN (AT)  
US26

### FINISHES



US15  
Satin Nickel



US26  
Polish Chrome



US26D  
Satin Chrome  
(SOHO & Deadbolt only)

### Spring Latches for AM Series (SH/HW/AT)

Optional: G90A3T square corner

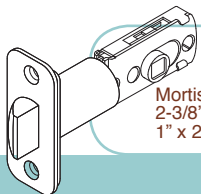

G90A3R

Mortise Spring Latch  
2-3/8" or 2-3/4" adjustable backset  
1" x 2-1/4" Round Corner Faceplate

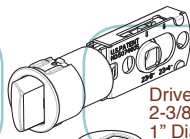

G90A3C

Drive-in Spring Latch  
2-3/8" or 2-3/4" adjustable backset  
1" Diameter

D927

Spring latch drive-in cap for converting mortise latch to Drive-in Latch

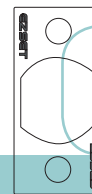

9782-square 9783-round

4-way plate is available for converting drive-in latch to 1" x 2-1/4" square mortise latch.

# ANSI Grade 3



## 5-1/2" CTC INTERCONNECTED LOCK IP / IQ / IS NEW!

## 200LT DEADBOLT



IP  
US26

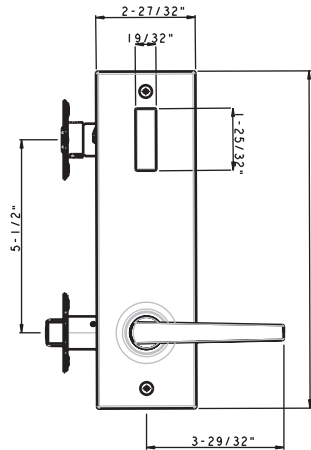

IP - AM Series lever on bath side.  
IQ - 500T Series lever on both side.  
IS - 500T Series lever outside,  
AM series lever inside.

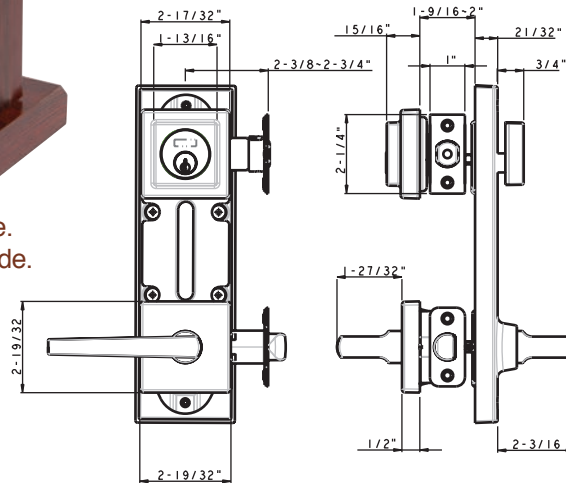

### SPECIFICATIONS

Door Prep  
Door Fitting

2-1/8" cross bore, 1" edge bore.  
Handleset: 1-3/8"~1-3/4", 2" door with thick door kit.  
Deadbolt/Lever 1-3/8"~2".

Cylinder  
Latch

KW1 standard, SC1 optional.  
2-3/8" and 2-3/4" adjustable.  
UL latch for IS/IP series.

Latch Bolt

Deadbolt: 1" throw.  
Lever: 1/2" throw.

Strike  
Door Handing  
ADA

2-1/4" full lip round corner.  
Handleset/Privacy Lever: handed (specify LH or RH when ordering).  
Deadbolt Interior turn piece & Privacy Lever with Push Button.  
Meets 4.13.9 ADA requirements.



LTR  
US26

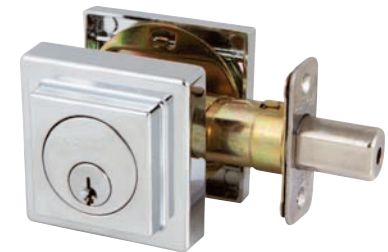
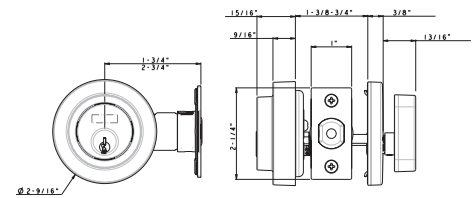

LTS  
US26

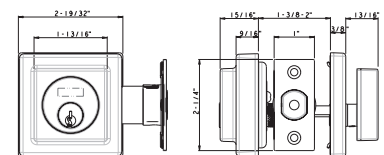

# Interconnected

## ENTRANCE HANDLESETS



CHATEAU (CH)  
US10B

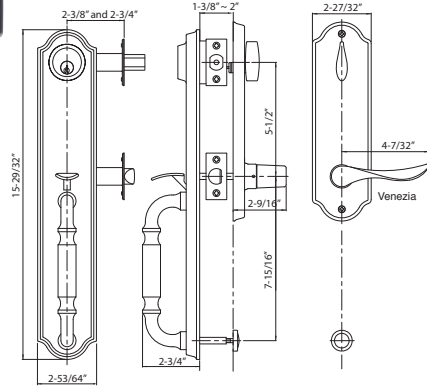

FAIRMONT (FT)  
US15

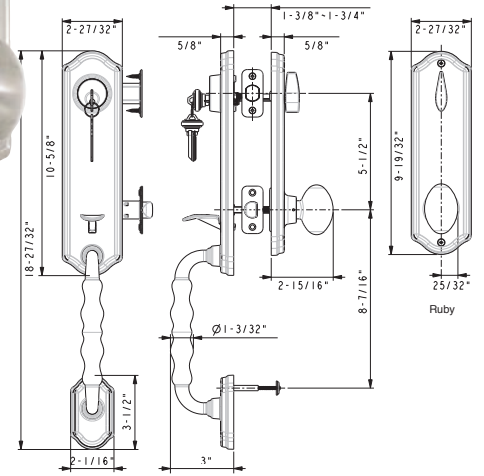

RICHMOND (RI)  
PVD

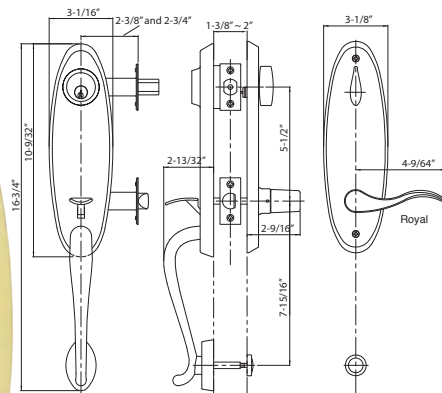

HAMPTON (HA)  
US12P

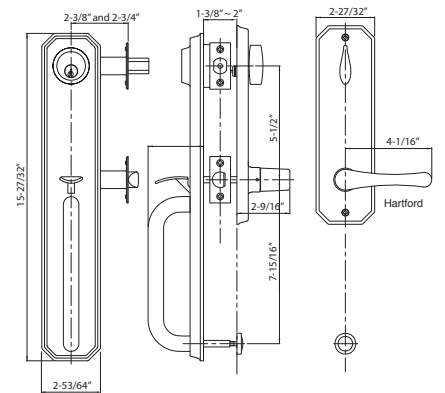

# ANSI Grade 2

## 4" CTC IL SERIES



300IL-SD-US15  
San Diego (SD) Lever



301IL-CT-US15  
Charlotte (CT) Lever

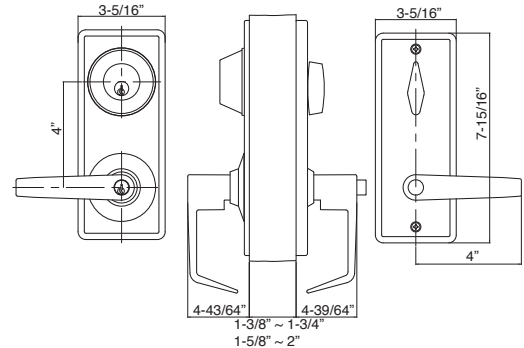

## 5-1/2" CTC IZ SERIES

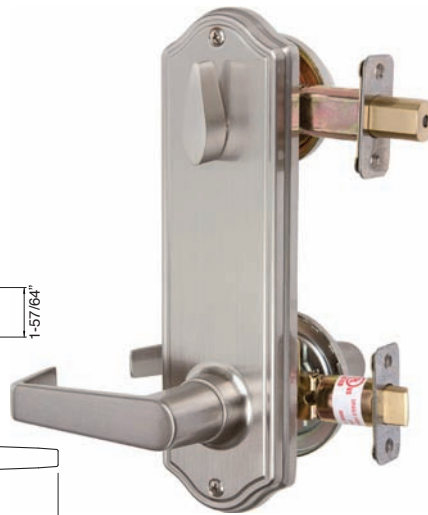
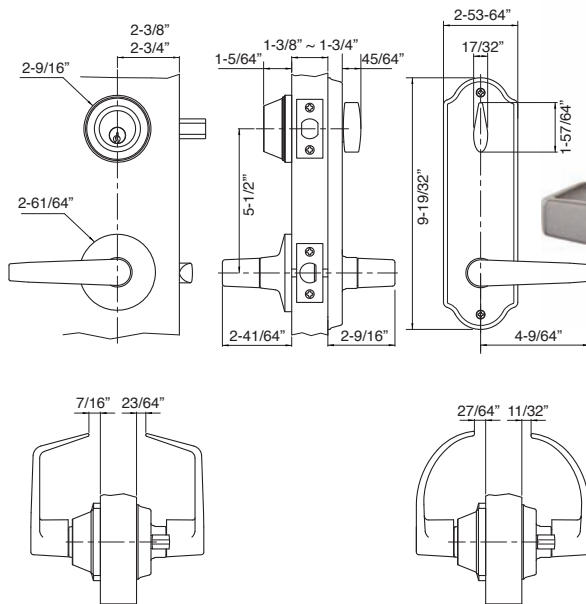

301IZ-CT-US15  
Charlotte (CT) Lever

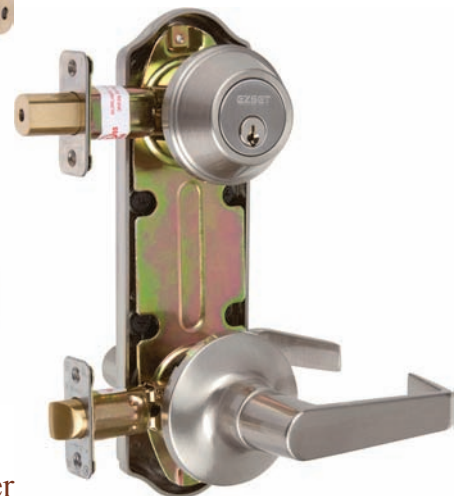

### INTERIOR APPLICATION



South Bay

Escort

### Spring Latches for Interconnected Lock

Optional: 9079 square corner  
9079UL UL square corner  
9079RUL UL round corner

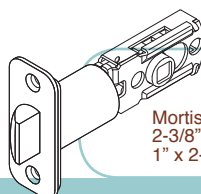

9079R

Mortise Spring Latch (Brass Bolt)  
2-3/8" or 2-3/4" adjustable backset  
1" x 2-1/4" Round Corner Faceplate



by PHILADELPHIA HARDWARE GROUP

# Handlesets & Levers

## 400 SERIES HANDLESETS



MAYFAIR (MA)  
US10B



IMPERIAL (IM)  
US15



KELLINGTON (KN)  
US12P



## 500T SERIES LOCKSETS



ROYAL (RY)  
US10B



MANHATTAN (MH)  
US5



ESCORT (ET)  
US3



PALMER (PA)  
US26



SHELBY (SY)  
US12P



JURAN (JU)  
US15A



# Lever Design

## 500T SERIES LOCKSETS



# Knob Design

## 100T SERIES LOCKSETS



### COMBOSET 300T Series

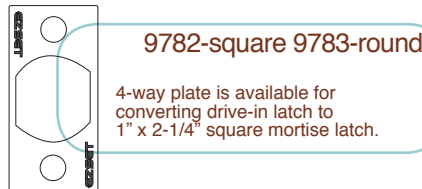

## ANSI Grade 3

### Dead Latches for 500TZ Entrance

Optional: 9045 square corner

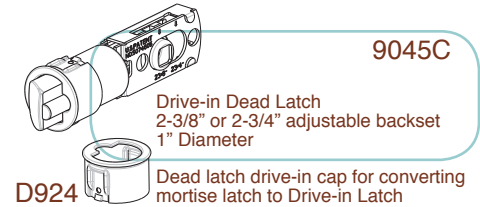
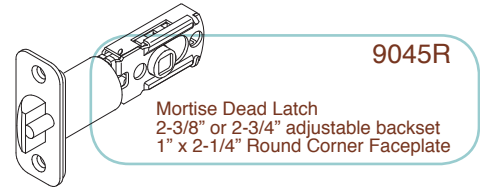

### Spring Latches for 101T, 102T, 501TZ, 502TZ

Optional: 9072 square corner

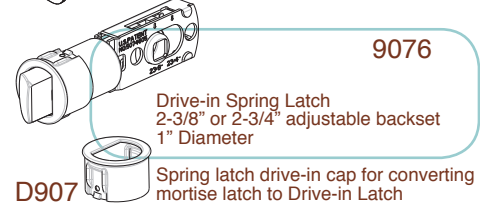

### Dead Latches for 100T Entrance

Optional: 9071 square corner

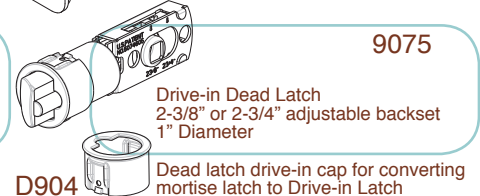

# Deadbolt

## 200B SERIES



SINGLE CYLINDER  
US3



DOUBLE CYLINDER  
US3



ONE SIDED (Full Bore)  
US32D



ONE SIDED (Half Bore)  
US32D

### Latches for 200B

Optional: 9091 square corner  
9091UL UL square corner  
9092UL UL round corner

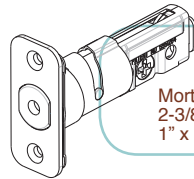

9092  
Mortise Deadbolt Latch  
2-3/8" or 2-3/4" adjustable backset  
1" x 2-1/4" Round Corner Faceplate

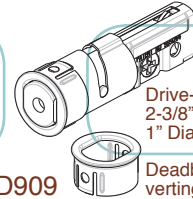

9093  
Drive-in Deadbolt Latch  
2-3/8" or 2-3/4" adjustable backset  
1" Diameter

D909

Deadbolt latch drive-in cap for converting mortise latch to Drive-in Latch

# Sliding

## DOOR LOCK

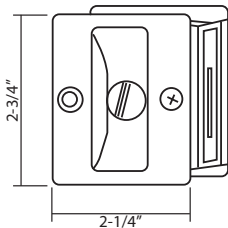

US3  
Passage



US15  
Privacy

### SPECIFICATIONS

Door Prep  
Door Fitting  
Exposed Trim  
Strike

2-1/4" H x 1-3/4" W notch.  
1-3/8" ~ 1-3/4" door thick.  
Brass, stainless steel, or zinc alloy.  
1" x 2-1/4" rectangular.

**NEW!**

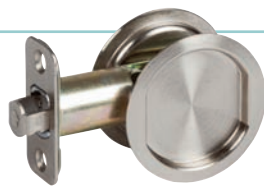

US15  
Passage

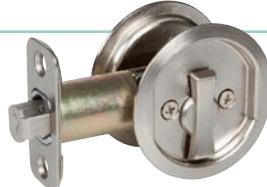

US15  
Privacy

Fits 2-1/8" cross bore  
2-3/8" fixed  
backset latch

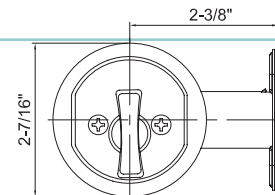

### FINISHES



PVD  
Lifetime



US3  
Polish Brass



US5  
Antique Brass



US10B  
Oil Rubbed Bronze



US12P  
Tuscany Bronze



US15  
Satin Nickel



US15A  
Pewter



US26  
Polish Chrome

Not all styles available in all finishes. See finish chart on page 10 for details.

# Finish

## AVAILABILITY

SERIES	ITEM	Abbrev	PVD	US3	US5	US10B	US12P	US15	US15A	US26	US26D	US32D
			505	605	609	613		619	620	625	626	630
Interconnected Handleset and Solid Brass Levers												
400 Interconnected	CHATEAU	(CH)	●			●	●	●	●	●		
	FAIRMONT	(FT)	●			●	●	●	●	●		
	HAMPTON	(HA)	●			●	●	●	●	●		
	RICHMOND	(RI)	●			●	●	●	●	●		
Handleset, Interconnected Lock, Levers, Knob, Deadbolt and Combo Pack												
400 2PC Type	IMPERIAL	(IM)	●	●	●	●	●	●	●	●		
	KELLINGTON	(KN)				●	●	●	●	●		
	MAYFAIR	(MA)		●		●	●	●	●	●		
500T	CAMBER	(CM)				●	●	●	●	●		
	ESCORT	(ET)		●	●	●				●		
	JURAN	(JU)		●		●	●	●	●	●		
	MANHATTAN	(MH)		●	●	●	●	●	●	●		
	PALMER	(PA)		●		●	●	●	●	●		
	ROYAL	(RY)	●	●	●	●	●	●	●	●		
	SHELBY	(SY)				●	●	●	●	●		
300IL 4"CTC			●		●		●					
300IZ 5-1/2CTC							●					
200B	DEADBOLT		●	●	●	●	●	●	●		●	
100T	BALA	(BA)		●	●	●	●	●	●	●		●
	GUARDIAN	(GN)		●	●							●
	OLYMPUS	(OS)		●	●	●	●		●	●		●
	RUBY	(RB)		●	●	●	●		●	●		●
300T/310T Combo				●							●	
Contemporary Interconnected Lock, Levers and Deadbolt												
500AM	AUSTIN	(AT)						●		●		
Contemporary	HOLLYWOOD	(HW)						●		●		
	SOHO	(SH)						●		●	●	
301IP 5-1/2" CTC							●		●			
301IS 5-1/2" CTC							●		●			
200TS	DEADBOLT						●		●			
200TR	DEADBOLT						●		●			

● Product available in stock. Please refer to price book for details. Other finishes may be available upon request. Please allow longer lead time, min. 300 lock order.

# Accessories

## Lock Strikes



**9101**  
1-1/8" x 2-3/4"  
"T" type with tab



**9102**  
1-3/4" x 2-1/4"  
Full lip with tab square corner



**9103**  
1-3/4" x 2-1/4"  
Full lip with tab 1/4" radius round corner



**9108**  
1-3/4" full round with tab for tubular type drive-in latch

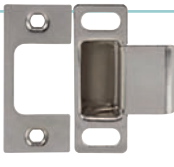

**9125**  
1-1/4" x 2-3/4"  
"T" type adjustable

## Deadbolt Strikes



**9111**  
1-1/8" x 2-3/4"  
Rectangular square corner



**9112**  
1" x 2-1/4"  
Rectangular square corner



**9113**  
1" x 2-1/4"  
Rectangular 1/4" radius round corner



**9117**  
1-3/4" x 2-1/4"  
Full lip 1/4" radius round corner



**9119**  
1-1/4" x 3-5/8"  
Security strike 1/4" radius round corner



**9119F**  
1-7/8" x 3-5/8"  
Full Lip Security Strike 1/4" radius round corner

## Keys



TE5



HK5

KW1 5-Pins

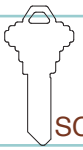

SC5

SC1 5-Pins



HK6

SC4 6-Pins

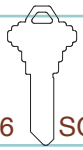

SC6



9301-K  
KW1



9301-S  
SC1 & SC4





DISTRIBUTION BY:



## Philadelphia Hardware Group Inc.

**SAN DIEGO DISTRIBUTION CENTER**

(Home Office)  
6590 Top Gun Street  
San Diego, CA 92121  
Tel: (858) 642-0450  
Fax: (858) 642-0454  
Toll Free Tel: 1-800-545-2309  
Toll Free Fax: 1-800-828-0988  
[www.philihardware.com](http://www.philihardware.com)

**CHICAGO DISTRIBUTION CENTER**

3687 Darlene Court  
Aurora, IL 60504  
Toll Free Tel: 1-800-545-2309

**ATLANTA DISTRIBUTION CENTER**

2319 Defoor Hills Road N.W.  
Atlanta, GA 30318  
Toll Free Tel: 1-800-545-2309

**DALLAS DISTRIBUTION CENTER**

4653 Leston Avenue, Suite 703  
Dallas, TX 75247  
Toll Free Tel: 1-800-545-2309